

Setup Guide Freedom (T7460)



Items Included



1

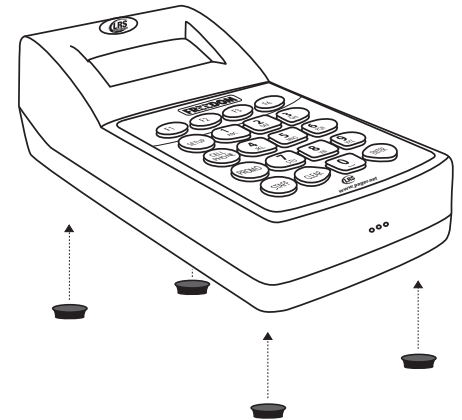

2

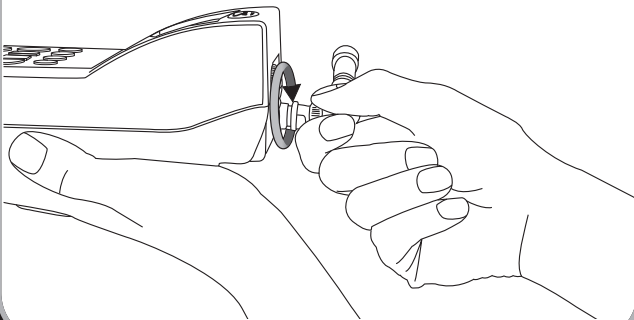

3

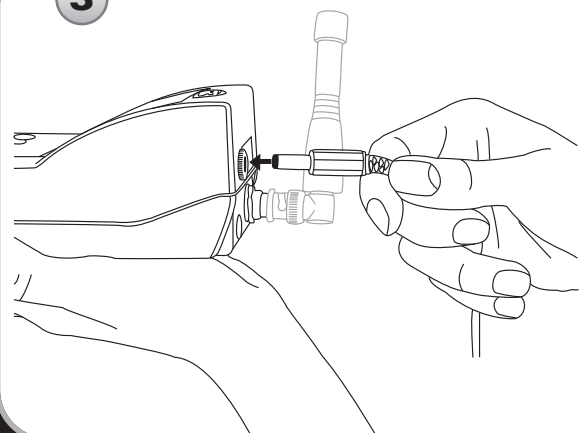

4

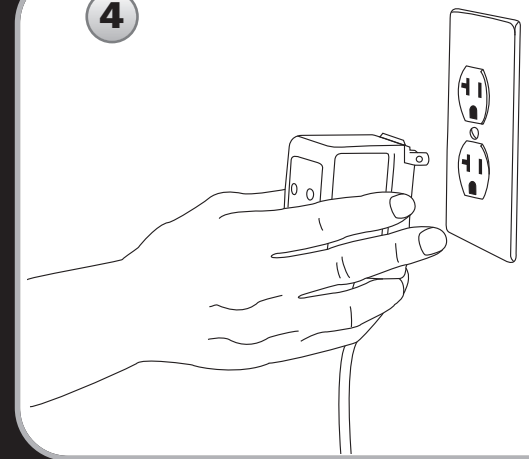

5



6

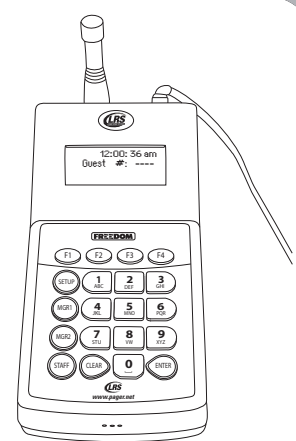

For Cell Phone Messaging:

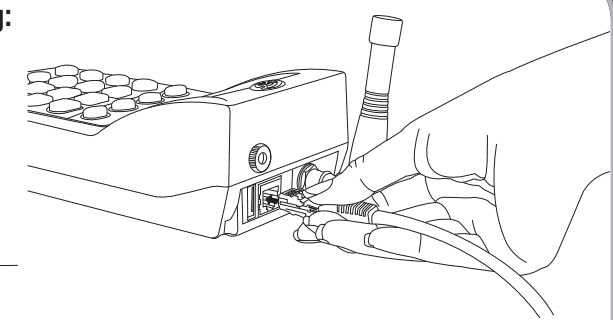
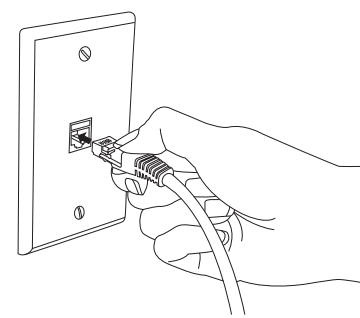

FREEDOM TRANSMITTER (T7460) BASIC OPERATIONS GUIDE

PAGING

Guest Pagers: Return guest pagers to charging unit after paging

Non-Alphanumeric (Adverteaser, Pizza, Lobster, Coaster Call pagers)

1. Main screen displays – Guest #: - - - -
2. Enter number assigned to guest at handout
3. Press **ENTER** to send page

Alphanumeric (Alpha Coaster pager)

1. Main screen displays – Guest #: - - - -
2. Enter number assigned to guest at handout
3. Enter message code (000-099) (see Canned Messages Table)
4. Press **ENTER** to send page
(You may also Press **F1** (V1), **F2** (V2) or **F3** (V3) to send the message with 1, 2, or 3 vibrations or **F4** (Exit) to Cancel the page)

PRESET MESSAGES

Using Message Codes:

When prompted for a message:

1. Enter message number code (and a numeric extension – optional)
2. Press **ENTER**

Example: Send a message to call extension 123

From Canned Message Table below, choose – 006 (Call Ext)
Enter code **0-0-6-1-2-3** (Displays: CALL EXT 123)

Create Additional Alpha Messages: For Alpha pagers only

1. Press **SETUP**
2. Enter Password (Default: **5-6-7-8-9**)
3. Press **3** Other
4. Press **1** (Canned Msgs.)
5. Press **F1** (EDIT)
6. Press **F2** (NEW) to write a new message (Press **F1** (EDIT) to edit displayed message)
7. Enter message using alphanumeric typing (i.e. for letter 'E' press #2 twice)
8. Press **ENTER** to save then **F4** (EXIT) when finished

Staff Pagers:

Non-Alphanumeric (Star Pager)

1. On keypad press **STAFF** (Display = Staff #: - - - -)
2. Enter staff pager number to be paged
3. Press **ENTER** to send page

Alphanumeric (Alphanumeric, Rechargeable alphanumeric pagers)

1. On keypad press **STAFF** (Display = Pager #: - - - -)
2. Enter staff pager number to be paged
3. Enter message code (000-099) (see Canned Messages Table)
4. Press **ENTER** to send page
(You may also Press **F1** (V1), **F2** (V2) or **F3** (V3) to send the message with 1, 2, or 3 vibrations or **F4** (Exit) to Cancel the page)

All Staff Page: Page all alphanumeric staff pagers simultaneously

1. Press **SETUP**
2. Press **9-1-1** then **ENTER**
3. Enter message number code (000-099)
4. Choose **F1** (V1), **F2** (V2) or **F3** (V3) for 1, 2 or 3 vibrations

MISC. FUNCTIONS

Anti-Theft Mode: (Signal pagers that are out of range)

1. Press **SETUP**
2. Enter Password (Default: **5-6-7-8-9**)
3. Press **1** System
4. Press **1** Anti-Theft
5. Press **F1** (ON) to activate anti-theft mode or (press **F4** to turn OFF)
6. Main screen display will show "T" on upper left corner when turned on

Set Time/Date:

1. Press **SETUP**
2. Enter Password (Default: **5-6-7-8-9**)
3. Press **1** System
4. Press **3** Date/Time
5. Press **1** for Date Format, Press **2** for Time Format, Press **3** to Set Date, or Press **F2** (DN-Down) then Press **1** to Set Time

Cell Phone Paging

Entering a Cell Phone Number:

1. When a customer first checks in, press **CELL PHONE**
2. Enter the customer's cell phone number and press **ENTER**
(Note: The cell phone number entered must include the area code)
3. The transmitter will display a pager number for the cell phone number
4. Write that pager number down for future reference
5. Press **ENTER** to complete the cell phone entry process

Paging a Cell Phone:

1. Main screen displays – Guest #: - - - -
2. Key in the pager number written down earlier for the cell phone you wish to page
3. Press **ENTER** to page

Turn On Cell Phone Paging:

1. Press **SETUP**
2. Enter Password (Default: **5-6-7-8-9**)
3. Press **1** System
4. Press **2** Cell Paging
5. Press **1** Enabled
6. Press **F1** (Yes)

Turn On Network:

1. Press **SETUP**
2. Enter Password (Default: **5-6-7-8-9**)
3. Press **3** Other
4. Press **F2** (Down)
5. Press **3** Network
6. Press **1** Enabled
7. Press **F1** (Yes)

*For advanced features, go to pager.net for a complete user manual.
For technical support call Long Range Systems at 800-437-4996.*

Preset Message Code

Code	Message	Code	Message	Code	Message
000	Phone Call	020	Starter	038	Kitchen
001	Sales Call	021	Service Drive	039	Bar
002	Manager	022	Showroom	040	Door
003	Customer	023	Parked Call	041	Survey
004	Room	024	Voice Mail	042	T-xxx Q-mm
005	Visitor	025	Dressing Room	043	Break
006	Call Ext	026	Price Check	044	Fire
007	MTG Room	027	Department	045	Unit
008	Lane	028	Cashier	046	Window
009	Aisle	029	Office	047	Nurse
010	Void	030	Table	048	Register
011	Stamps	031	Winner	049	Owner
012	Change	032	Pickup	050	Check
013	Station	033	Dock	051	Drink
014	Machine	034	You Have Mail	052	Food
015	Operator	035	Table Ready	053	Service
016	Emergency	036	No Special	054	Seat
017	XX Minutes	037	Hole	055	Booth
018	Tee			056	Lobby
019	Pro Shop			057	Help
				058	Restroom
				059	Valet
				060	Car
				061	Bus
				062	Bay
				063	Low Battery
				064	Error
				065	Exit
				066	Fax
				067	Host
				068	Space
				069	Location
				070	Nursery
				071	Teller
				072	Officer
				073	Buffet
				074	Diaper Change
				075	Child Crying
				076	To Nursery



800.437.4996 • 214.553.5308
www.pager.net
XU-0117 091610